

SUPPLY

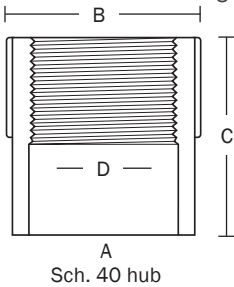

842-72P



## Standard Adapter

FIP Thread × Sch. 40 Hub Connection

- Combine these adapters with any of our 842-\_L\_ drains or 852-\_L\_ cleanout tops

DRAINAGE

SUPPORT

PVC Item No	ABS Item No	Dimensions				Pkg	Min Qty	Case Qty
		A	B	C	D			
<b>NEW</b> 842-712P	842-712A	1½" × 2	2⅝"	2⅜"	2" FIP	B	10	10
842-72P	842-72A	2"	2¾"	2½"	2" FIP	B*	5	5
842-73P	842-73A	3"	4"	3⅜"	3" FIP	B*	5	5
842-74P	842-74A	4"	5"	3⅜"	4" FIP	B*	10	10
842-76P	842-76A	6"	6½"	5⅝"	6" FIP	B*	8	8

APPENDIX



842-82PT

## Trap Primer Adapter

FIP Thread × Sch. 40 Hub Connection

- ½" FIP tapped/plugged trap primer port
- Combine these adapters with any of our 842-\_L\_ drains or 852-\_L\_ cleanout tops

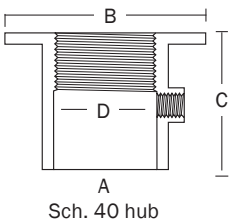

PVC Item No	ABS Item No	Dimensions				Pkg	Min Qty	Case Qty
		A	B	C	D			
842-82PT	842-82AT	2"	4 <sup>11</sup> / <sub>16</sub> "	3 <sup>3</sup> / <sub>8</sub> "	2" FIP	B*	1	10
842-83PT	842-83AT	3"	6"	4"	3" FIP	B*	1	10
842-84PT	842-84AT	4"	7"	4 <sup>1</sup> / <sub>4</sub> "	4" FIP	B*	1	10

## Fitting Socket Adapter

FIP Thread × Sch. 40 Spigot Connection

- Fits into Sch. 40 hub



842-92P

Use a poly flush plug with the 842-9 Series fitting socket rings for an inexpensive cleanout or threaded access cover.

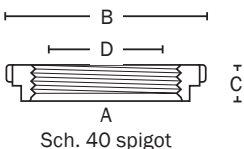
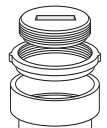

PVC Item No	ABS Item No	Dimensions				Pkg	Min Qty	Case Qty
		A	B	C	D			
842-92P	842-92A	2"	2¾"	½"	2" FIP	B	10	20
842-93P	842-93A	3"	4 <sup>1</sup> / <sub>16</sub> "	⅝"	3" FIP	B	10	20
842-94P	842-94A	4"	5 <sup>1</sup> / <sub>16</sub> "	⅝"	4" FIP	B	10	20